

Wyznacz wartości reakcji podporowych poniżej belki. Narysuj schemat pracy belki i wyznacz także siły w przegubie.

### Zadanie nr 1

Kąt nachylenia siły  $P=25\text{kN}$  do osi belki do  $30^\circ$ .

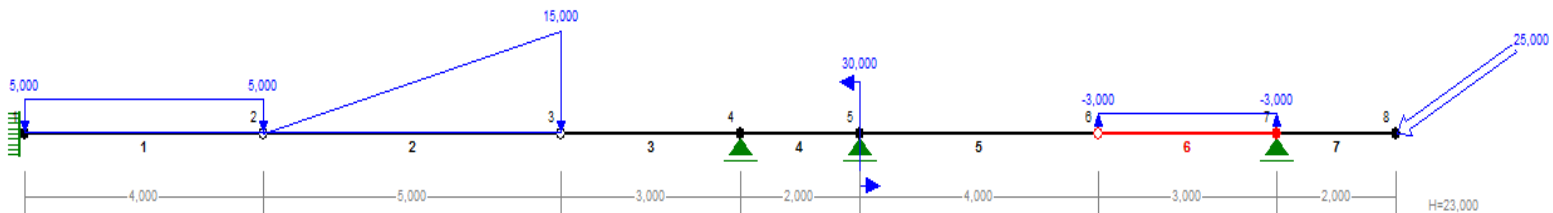

### Zadanie nr 2

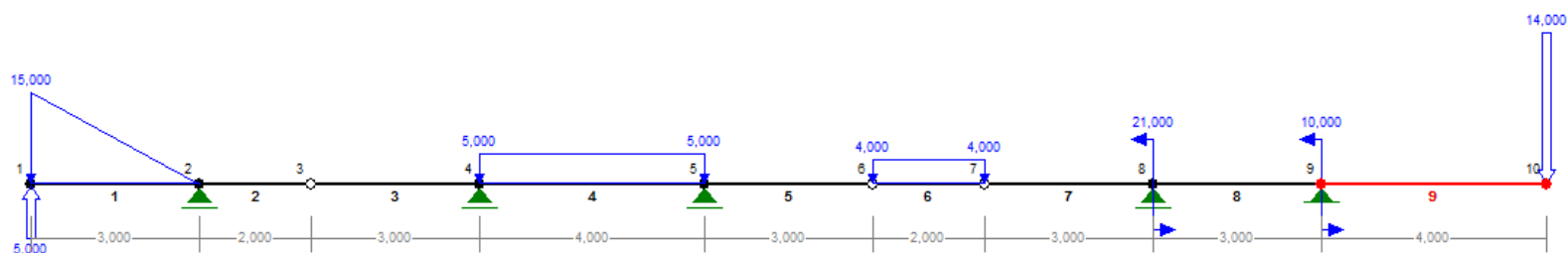

### Zadanie nr 3

Kąt nachylenia siły  $P=27\text{kN}$  do osi belki do  $60^\circ$ .

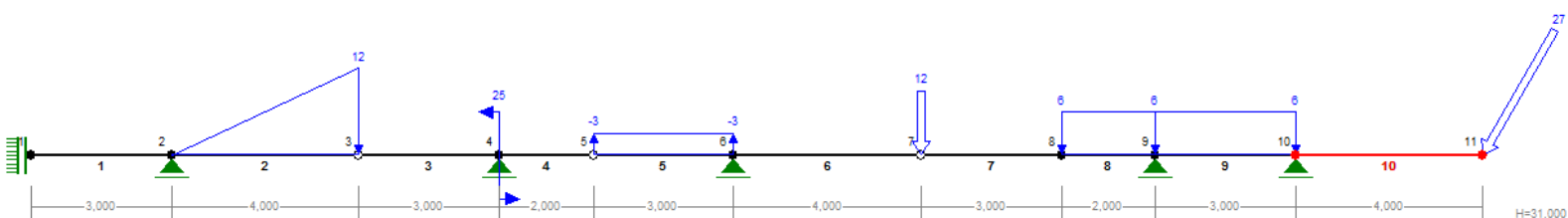

### Zadanie nr 4

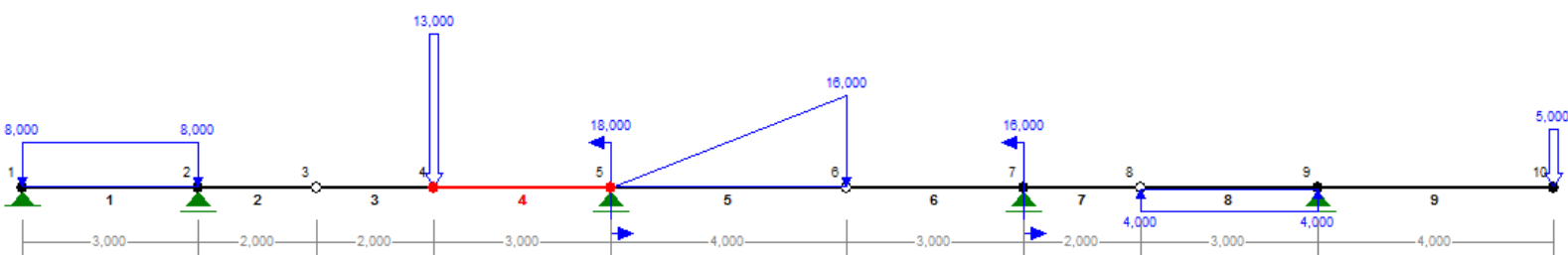

Wyniki:

Zadanie 1:

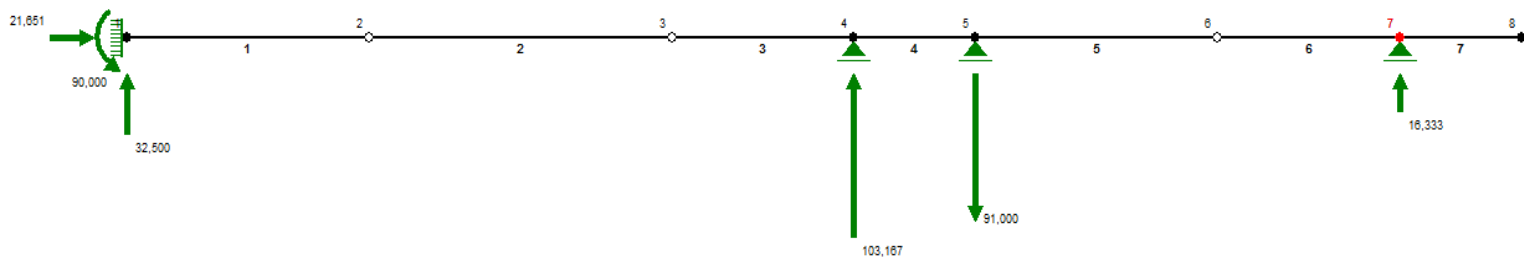

Zadanie 2:

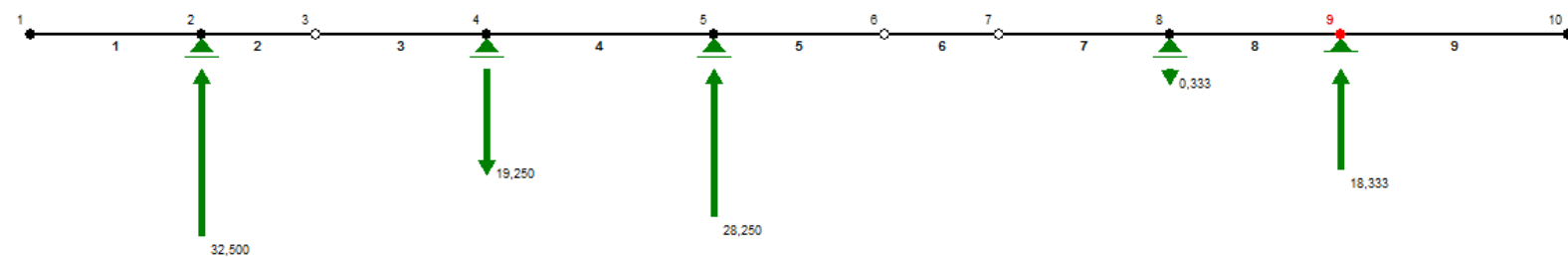

Zadanie 3:

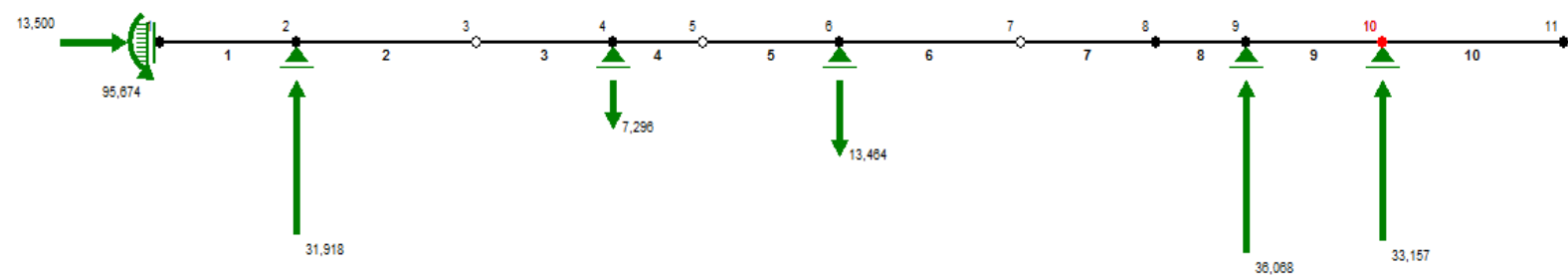

Zadanie 4

